



36, Burfield Court Handcross Road, Luton, Bedfordshire, LU2 8JY
£850 PCM



- EXCLUSIVE TO PR PROPERTY LETTINGS
- CLOSE TO M1 AND STATION
- AVAILABLE JUNE 2026

- ONE BEDROOM APARTMENT
- CLOSE TO AIRPORT
- MUST BE VIEWED

- PARKING ON SITE
- WIGMORE LOCATION

Exclusive to P&R Property — Tucked away in the popular and well-connected Wigmore area of Luton, this well-presented one bedroom apartment is a fantastic opportunity for those seeking modern, fuss-free living. The open plan living space creates a bright and versatile feel throughout, ideal for those who love to make the most of their home. With on-site parking, an ASDA at Wigmore Hall Shopping Centre just around the corner, and swift access to the M1 and Luton Airport, everything you need is right on your doorstep. Available June 2026 — and trust us, this one really does need to be seen to be appreciated.

ENTRANCE HALL

Laminate flooring, door to:

OPEN PLAN LIVING ROOM TO KITCHEN 17'1" X 15'9" (5.21M X 4.79M)

Double glazed window to front, double glazed window to side, laminate flooring, fitted with a matching range of base and eye level units with worktop space over, stainless steel sink with tiled splashbacks, space for fridge/freezer and washing machine, fitted electric oven, built-in four ring hob with extractor hood over, door to:

BEDROOM 1 9'1" X 6'5" (2.77M X 1.95M)

Laminate flooring, fitted wardrobes.

BATHROOM

Fitted with three piece suite comprising bath with electric shower over, wash hand basin and close coupled WC, electric fan heater, extractor fan, obscure double glazed window to side, tiled flooring.

OUTSIDE

PARKING

Car parking at front of building.

Second Floor

Approx. 30.5 sq. metres (328.0 sq. feet)

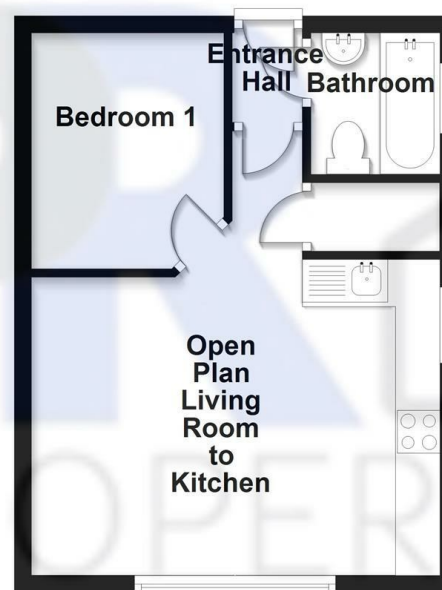

Total area: approx. 30.5 sq. metres (328.0 sq. feet)

36 burfield court

Energy Efficiency Rating		Current	Potential
Very energy efficient - lower running costs			
(92 plus)	A		
(81-91)	B		
(69-80)	C		79
(55-68)	D	61	
(39-54)	E		
(21-38)	F		
(1-20)	G		
Not energy efficient - higher running costs			
England & Wales		EU Directive 2002/91/EC	